



49 Marlow Road

London, SE20 7YG

£1,700 PCM

Galloways are delighted to present this two double bedroom ground floor maisonette nestled in the heart of Marlow Road. The property boasts an impressive floor space of 750 square feet with additional garden space. The flat benefits from its own front and rear garden with sole use. The landlord is offering the property part furnished or unfurnished. Free parking is available on Marlow Road.

Bromley Council Tax Band C £1,638pa

Viewing

Please contact our Galloways Penge Office on 020 8778 1120 if you wish to arrange a viewing appointment for this property or require further information.

- TWO DOUBLE BEDROOM
- GROUND FLOOR
- GARDEN
- VICTORIAN
- SEPERATE KITCHEN
- OWN FRONT DOOR
- RECENTLY REDECORATED
- 16 MINUTE WALK TO ANERLEY STATION
- 6 MINUTE WALK FROM BIRKBECK STATION
- (ALL WALKING DISTANCES ESTIMATED VIA GOOGLE MAPS)



2



1



2



D

Floor Plan

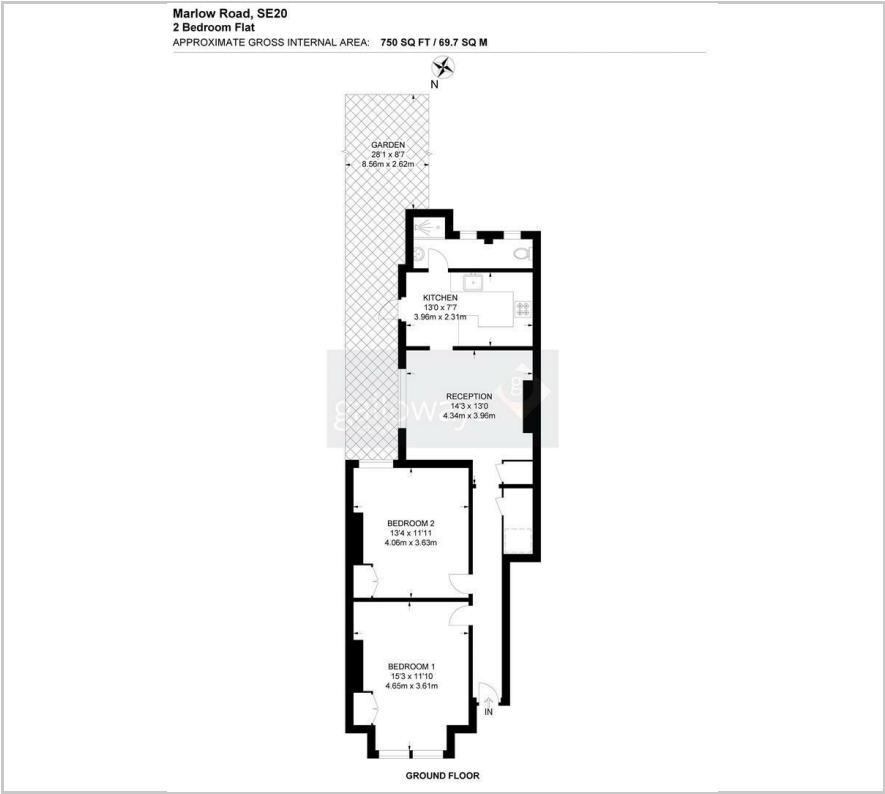

Area Map



Energy Efficiency Graph

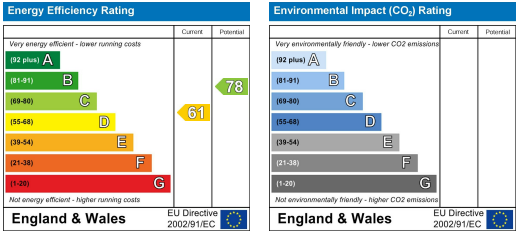

These particulars, whilst believed to be accurate are set out as a general outline only for guidance and do not constitute any part of an offer or contract. Intending purchasers should not rely on them as statements of representation of fact, but must satisfy themselves by inspection or otherwise as to their accuracy. No person in this firms employment has the authority to make or give any representation or warranty in respect of the property.